

Plan Reference

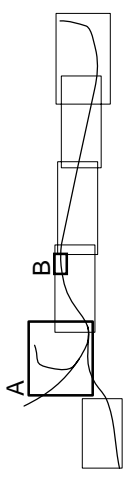

Note: Insert B indicates a Noise & Vibration Measurement Position adjacent to 43 Queen Elizabeth Avenue (see Plan Reference above for position along the GARL route).

Key:

- GARL Route
- Watercourse
- ⊗ Potentially Contaminated Land (Based on known historical uses) (See Vol 2: Ch 11)
- ⊗ Licensed Waste Management Site (Within LOD & LLAU) (See Vol 2: Ch 11)
- ⊗ Licensed Waste Management Site (Outwith LOD & LLAU) (See Vol 2: Ch 11)
- ⊗ Noise & Vibration Measurement Position (See Vol 2: Ch 13)
- Air Quality Sensitive Receptors (See Vol 2: Ch 14)

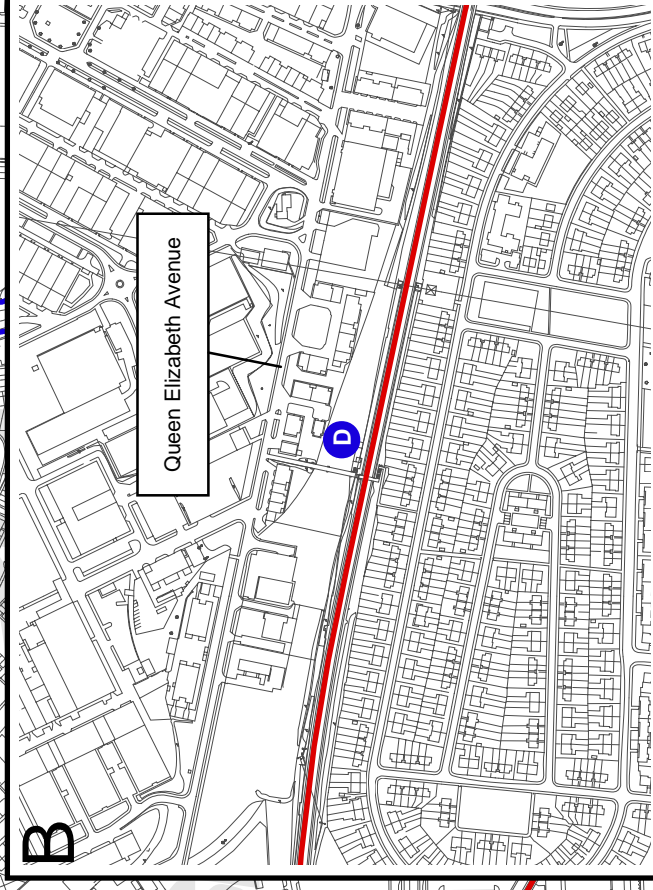
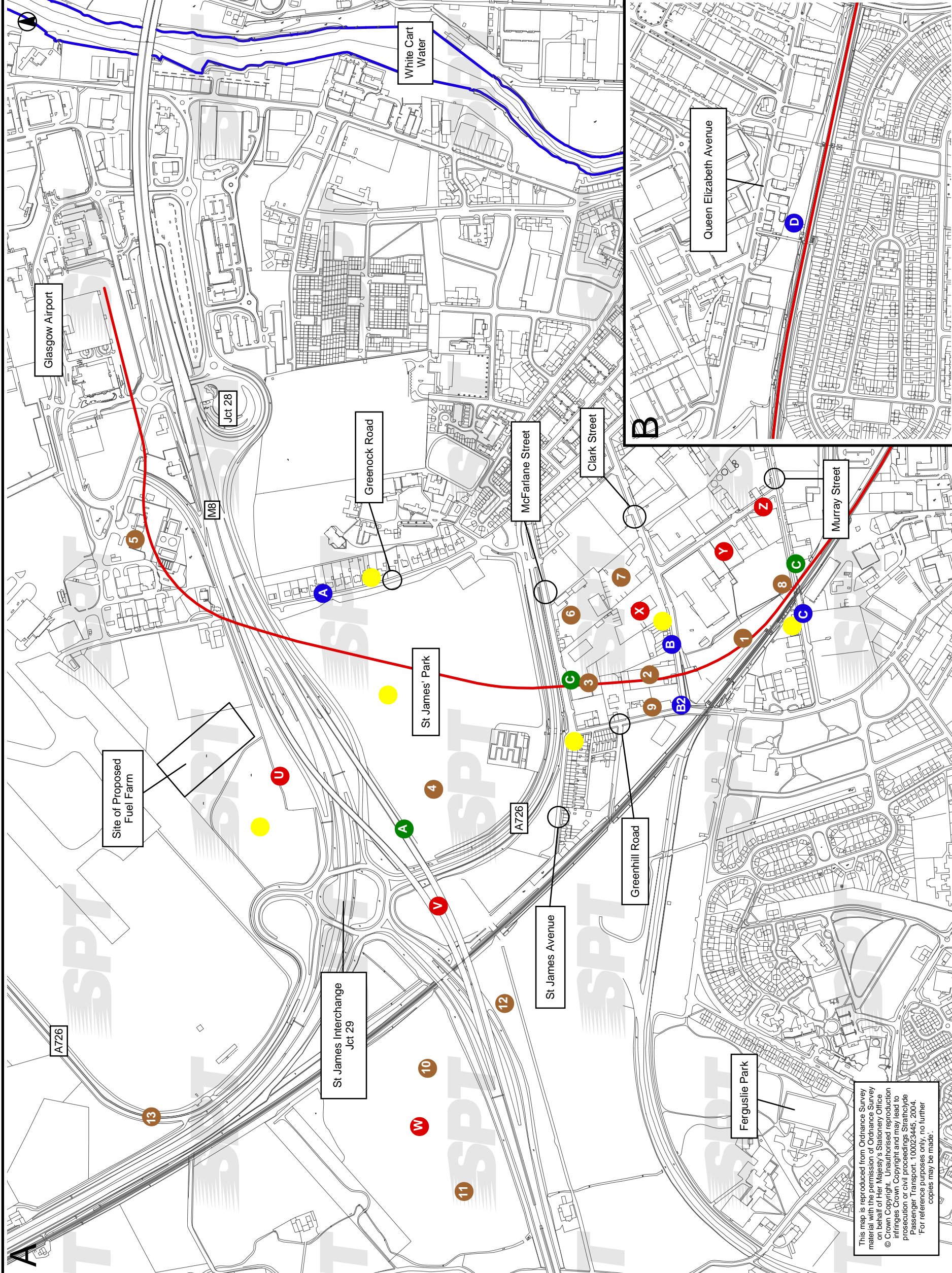

This map is reproduced from Ordnance Survey material with the permission of Ordnance Survey on behalf of Her Majesty's Stationary Office © Crown Copyright. Unauthorised reproduction infringes Crown Copyright and may lead to prosecution or civil proceedings. Strathclyde Passenger Transport, 100023445, 2004. For reference purposes only, no further copies may be made.

Client:	STRATHCLYDE PASSENGER TRANSPORT	Title:	PRINCIPAL ROADS, ENVIRONMENTAL MONITORING POINTS AND OTHER SIGNIFICANT FEATURES	
	Project:		GLASGOW AIRPORT RAIL LINK	
Design:	NA	FABER MAUNSELL   AECOM	No. Figure 12.1	Rev: A
Chk'd:	BAC			
Date:	09-09-2005	Scale:	1:7500	
GIS:	MDM	App'd:	IAB	
Tel: +44 (0) 141 222 6400			www.fabermaunsell.com	
Fax: +44 (0) 141 222 6499			St Stephens House, 279 Bath Street, Glasgow, G2 4JL	